



Welded Outlets (Female Threaded)

A

Technical Features

- **Sizes Available (Nominal) :**
Pipe run : DN32/1 1/4" to DN200/8"
Outlet : DN15/1/2" to DN65/2 1/2"
 - **Pressure Data :**
Working Pressure: 21.7 bar (300 psi)
Note : FM rated working pressure on schedule 5 pipe or less is 12.1 bar (175 psi)
 - **Connections :** Weldable inlet and threaded female outlet according to ISO 7/1 or ANSI B1.20.1
 - **Specifications :** Forged steel according to ASTM A53, Grade A or B; Type E. For use on proprietary thin wall, schedule 5, 10 and 40 pipe.
- Note : References marked # are not FM approved.*

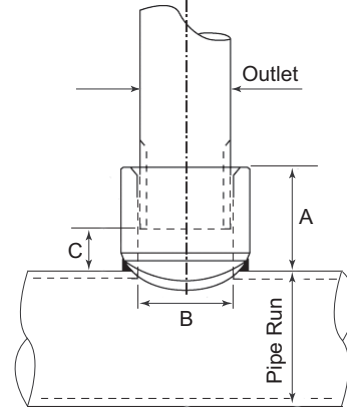

Welded Outlets - A

Physical Data

Pipe Run Nominal Pipe Size		Outlet Nominal Pipe Size		Outlet Thread Type	Dimensions (mm/inch)			Reference	Weight (kg/lbs)
metric	inch	metric	inch		A	B	C		
DN32	1 1/4"	DN15	1/2"	NPT	27.0 / 1.063	17.8 / 0.700	12.7 / 0.500	A050125150NPT	0.08 / 0.171
		DN20	3/4"	NPT	28.6 / 1.125	22.9 / 0.900	12.7 / 0.500	A075125150NPT	0.12 / 0.260
		DN25	1"	BSP	31.8 / 1.250	29.1 / 1.145	12.7 / 0.500	A100125150	0.15 / 0.331
		DN32	1 1/4"	BSP	34.9 / 1.375	37.8 / 1.490	12.7 / 0.500	A125125#	0.19 / 0.432
DN40	1 1/2"	DN15	1/2"	NPT	27.0 / 1.063	17.8 / 0.700	12.7 / 0.500	A050125150NPT#*	0.08 / 0.171
		DN15	1/2"	NPT	27.0 / 1.063	17.8 / 0.700	12.7 / 0.500	A050150200NPT**	0.08 / 0.171
		DN20	3/4"	NPT	28.6 / 1.125	22.9 / 0.900	12.7 / 0.500	A075125150NPT	0.12 / 0.260
		DN20	3/4"	NPT	28.6 / 1.125	22.9 / 0.900	12.7 / 0.500	A075150200NPT**	0.12 / 0.260
		DN25	1"	BSP	31.8 / 1.250	29.1 / 1.145	12.7 / 0.500	A100125150#	0.15 / 0.331
		DN25	1"	BSP	31.8 / 1.250	29.1 / 1.145	12.7 / 0.500	A100150200**	0.15 / 0.331
		DN25	1 1/4"	BSP	34.9 / 1.375	37.8 / 1.490	12.7 / 0.500	A125125#	0.19 / 0.432
		DN32	1 1/4"	BSP	34.9 / 1.375	37.8 / 1.490	12.7 / 0.500	A125150200	0.19 / 0.432
DN50	2"	DN40	1 1/2"	BSP	41.3 / 1.625	40.9 / 1.610	22.2 / 0.875	A150150#	0.22 / 0.477
		DN15	1/2"	NPT	27.0 / 1.063	17.8 / 0.700	12.7 / 0.500	A050150200NPT#	0.08 / 0.171
		DN15	1/2"	NPT	27.0 / 1.063	17.8 / 0.700	12.7 / 0.500	A050200250NPT*	0.08 / 0.171
		DN15	3/4"	NPT	28.6 / 1.125	22.9 / 0.900	12.7 / 0.500	A075150200NPT#	0.12 / 0.260
		DN20	3/4"	NPT	28.6 / 1.125	22.9 / 0.900	12.7 / 0.500	A075200250NPT*	0.12 / 0.260
		DN25	1"	BSP	31.8 / 1.250	29.1 / 1.145	12.7 / 0.500	A100150200#	0.15 / 0.331
		DN25	1"	BSP	31.8 / 1.250	29.1 / 1.145	12.7 / 0.500	A100200250	0.15 / 0.331
		DN32	1 1/4"	BSP	34.9 / 1.375	37.8 / 1.490	12.7 / 0.500	A125150200#	0.19 / 0.432
		DN32	1 1/4"	BSP	34.9 / 1.375	37.8 / 1.490	12.7 / 0.500	A125200250	0.19 / 0.432
		DN40	1 1/2"	BSP	41.3 / 1.625	40.9 / 1.610	22.2 / 0.875	A150200	0.22 / 0.477
DN65	2 1/2"	DN50	2"	BSP	44.5 / 1.750	52.5 / 2.067	22.2 / 0.875	A200200#	0.38 / 0.829
		DN15	1/2"	NPT	27.0 / 1.063	17.8 / 0.700	12.7 / 0.500	A050200250NPT**	0.08 / 0.171
		DN15	1/2"	NPT	27.0 / 1.063	17.8 / 0.700	12.7 / 0.500	A050250800NPT	0.08 / 0.171
		DN20	3/4"	NPT	28.6 / 1.125	22.9 / 0.900	12.7 / 0.500	A075200250NPT#	0.12 / 0.260
		DN20	3/4"	NPT	28.6 / 1.125	22.9 / 0.900	12.7 / 0.500	A075250800NPT	0.12 / 0.260
		DN25	1"	BSP	31.8 / 1.250	29.1 / 1.145	12.7 / 0.500	A100200250#	0.15 / 0.331
		DN25	1"	BSP	31.8 / 1.250	29.1 / 1.145	12.7 / 0.500	A100250300	0.15 / 0.331
		DN32	1 1/4"	BSP	34.9 / 1.375	37.8 / 1.490	12.7 / 0.500	A125200250**	0.19 / 0.432
DN32	1 1/4"	BSP	34.9 / 1.375	37.8 / 1.490	12.7 / 0.500	A125250300	0.19 / 0.432		



Welded Outlets (Female Threaded)

A

Welded Outlets - A					Physical Data (b)				
Pipe Run Nominal Pipe Size		Outlet Nominal Pipe Size		Outlet Thread Type	Dimensions (mm/inch)			Reference	Weight (kg/lbs)
metric	inch	metric	inch		A	B	C		
DN65	2 1/2"	DN40	1 1/2"	BSP	41.3 / 1.625	40.9 / 1.610	22.2 / 0.875	A150250	0.22 / 0.477
		DN50	2"	BSP	44.5 / 1.750	52.5 / 2.067	22.2 / 0.875	A200250	0.38 / 0.829
		DN65	2 1/2"	BSP	54.0 / 2.215	62.7 / 2.469	28.6 / 1.125	A250250#	0.55 / 1.250
DN80	3"	DN15	1/2"	NPT	27.0 / 1.063	17.8 / 0.700	12.7 / 0.500	A050250800NPT#	0.08 / 0.171
		DN20	3/4"	NPT	28.6 / 1.125	22.9 / 0.900	12.7 / 0.500	A075250800NPT#	0.12 / 0.260
		DN25	1"	BSP	31.8 / 1.250	29.1 / 1.145	12.7 / 0.500	A100250300#*	0.15 / 0.331
		DN25	1"	BSP	31.8 / 1.250	29.1 / 1.145	12.7 / 0.500	A100300400	0.15 / 0.331
		DN32	1 1/4"	BSP	34.9 / 1.375	37.8 / 1.490	12.7 / 0.500	A125250300#*	0.19 / 0.432
		DN32	1 1/4"	BSP	34.9 / 1.375	37.8 / 1.490	12.7 / 0.500	A125300400	0.19 / 0.432
		DN40	1 1/2"	BSP	41.3 / 1.625	40.9 / 1.610	22.2 / 0.875	A150300400	0.22 / 0.477
		DN50	2"	BSP	44.5 / 1.750	52.5 / 2.067	22.2 / 0.875	A200300	0.55 / 1.250
DN100	4"	DN65	2 1/2"	BSP	54.0 / 2.215	62.7 / 2.469	28.6 / 1.125	A250300	0.55 / 1.250
		DN15	1/2"	NPT	27.0 / 1.063	17.8 / 0.700	12.7 / 0.500	A050250800NPT#	0.08 / 0.171
		DN20	3/4"	NPT	28.6 / 1.125	22.9 / 0.900	12.7 / 0.500	A075250800NPT#	0.12 / 0.260
		DN25	1"	BSP	31.8 / 1.250	29.1 / 1.145	12.7 / 0.500	A100300400#	0.15 / 0.331
		DN32	1 1/4"	BSP	34.9 / 1.375	37.8 / 1.490	12.7 / 0.500	A125300400#	0.19 / 0.432
		DN40	1 1/2"	BSP	41.3 / 1.625	40.9 / 1.610	22.2 / 0.875	A150300400#	0.22 / 0.477
		DN40	1 1/2"	BSP	41.3 / 1.625	40.9 / 1.610	22.2 / 0.875	A150400	0.22 / 0.477
		DN50	2"	BSP	44.5 / 1.750	52.5 / 2.067	22.2 / 0.875	A200400	0.36 / 0.800
DN125	5"	DN65	2 1/2"	BSP	54.0 / 2.215	62.7 / 2.469	28.6 / 1.125	A250400	0.52 / 1.150
		DN15	1/2"	NPT	27.0 / 1.063	17.8 / 0.700	12.7 / 0.500	A050250800NPT#	0.08 / 0.171
		DN20	3/4"	NPT	28.6 / 1.125	22.9 / 0.900	12.7 / 0.500	A075250800NPT#	0.12 / 0.260
		DN25	1"	BSP	31.8 / 1.250	29.1 / 1.145	12.7 / 0.500	A100500800	0.15 / 0.331
		DN32	1 1/4"	BSP	34.9 / 1.375	37.8 / 1.490	12.7 / 0.500	A125500800	0.18 / 0.389
		DN40	1 1/2"	BSP	41.3 / 1.625	40.9 / 1.610	22.2 / 0.875	A150500800	0.22 / 0.477
		DN50	2"	BSP	44.5 / 1.750	52.5 / 2.067	22.2 / 0.875	A200500	0.34 / 0.743
DN150	6"	DN65	2 1/2"	BSP	54.0 / 2.215	62.7 / 2.469	28.6 / 1.125	A250500	0.52 / 1.150
		DN15	1/2"	NPT	27.0 / 1.063	17.8 / 0.700	12.7 / 0.500	A050250800NPT#	0.08 / 0.171
		DN20	3/4"	NPT	28.6 / 1.125	22.9 / 0.900	12.7 / 0.500	A075250800NPT#	0.12 / 0.260
		DN25	1"	BSP	31.8 / 1.250	29.1 / 1.145	12.7 / 0.500	A100500800#	0.13 / 0.291
		DN32	1 1/4"	BSP	34.9 / 1.375	37.8 / 1.490	12.7 / 0.500	A125500800#	0.18 / 0.389
		DN40	1 1/2"	BSP	41.3 / 1.625	40.9 / 1.610	22.2 / 0.875	A150500800#	0.22 / 0.477
		DN50	2"	BSP	44.5 / 1.750	52.5 / 2.067	22.2 / 0.875	A200600	0.34 / 0.743
DN200	8"	DN65	2 1/2"	BSP	54.0 / 2.215	62.7 / 2.469	28.6 / 1.125	A250600	0.52 / 1.150
		DN15	1/2"	NPT	27.0 / 1.063	17.8 / 0.700	12.7 / 0.500	A050250800NPT#	0.08 / 0.171
		DN20	3/4"	NPT	28.6 / 1.125	22.9 / 0.900	12.7 / 0.500	A075250800NPT#	0.12 / 0.260
		DN25	1"	BSP	31.8 / 1.250	29.1 / 1.145	12.7 / 0.500	A100500800#	0.13 / 0.291
		DN32	1 1/4"	BSP	34.9 / 1.375	37.8 / 1.490	12.7 / 0.500	A125500800#	0.18 / 0.389
		DN40	1 1/2"	BSP	41.3 / 1.625	40.9 / 1.610	22.2 / 0.875	A150500800#	0.22 / 0.477

Installation

The low weld volume design provides for either a partial or full penetration weld employing a single pass with minimum burn through and pipe distortion.

Note 1: References marked # will have a slight gap of 0.8mm/0.031" along the longitudinal center line of the Pipe

Run.

Note 2: References marked * can also be used on a Pipe Run of DN65/2 1/2"

Note 3: References marked ** can also be used on a Pipe Run of DN50/2"